

# Installation Instructions:

Kit#: **1-209, 1-210**

## FRONT TRUNNION BUSHING KIT (w/ PIVOT BUSHINGS [1-210])

AMC '64-'69



1-888-PROTHANE  
3560 Cadillac Ave., Costa Mesa, CA 92626

### PARTS LIST:

PART#:	DESCRIPTION
19-1750-001	TEFLON LUBE 5 GRM TUBE, PRINTED
SLV-60820	3/4 OD X .510 ID X 2.020" L GOLD ZINC
SLV-61055	.700 OD X .510 ID X .150 THICK GOLD ZINC
U-61156	AMC TRUNNION BUSHING 64-69
U-64234	AMC UPPER C-ARM BUSH, OUTER 64-69

QTY:  
2  
2  
2  
2  
4



Please refer to a factory service manual before any disassembly or reassembling of your vehicle for proper instructions. Check service manual to ensure proper torque specs during installation.

#### NOTE:

- Prothane bushings generally do **NOT** meet in the center. The "crush" or amount the bolt can be tightened is determined by the length of the sleeve.
- For all articulating bushings, make sure to apply SUPER GREASE (supplied) to **ALL SURFACES** of bushings that contact metal.
- For all stationary bushings, we recommend applying a light coat of lithium or teflon grease (not supplied) to OD and ID of bushings to aid installation.
- **REUSE** all factory hardware unless replacement pieces are supplied.

\*\*Prothane Motion Control highly recommends this and all our polyurethane suspension kits be installed by a qualified technician.\*\*

### INSTALLATION:

**\*\*NOTE: All factory bushings and inner sleeves MUST BE REMOVED before installing new PROTHANE bushings.\*\***

### Assembly View:

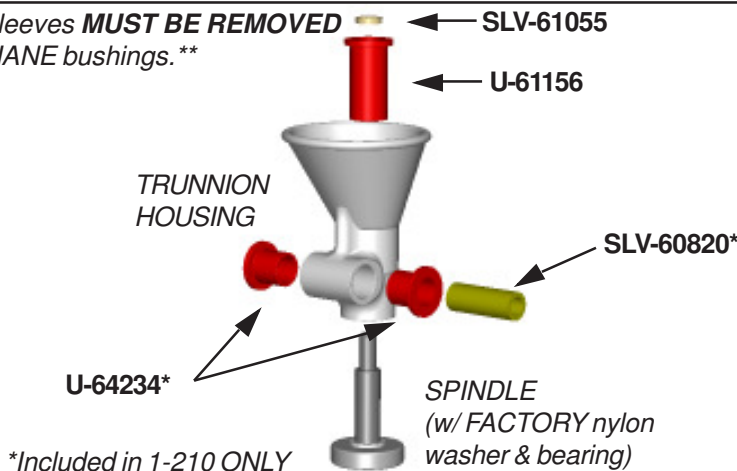

\*Included in 1-210 ONLY

FORM 1-209

FOR TECHNICAL ASSISTANCE CALL 1-888-PROTHANE

# Installation Instructions:

Kit#: **1-209, 1-210**

## FRONT TRUNNION BUSHING KIT (w/ PIVOT BUSHINGS [1-210])

AMC '64-'69



1-888-PROTHANE  
3560 Cadillac Ave., Costa Mesa, CA 92626

### PARTS LIST:

PART#:	DESCRIPTION
19-1750-001	TEFLON LUBE 5 GRM TUBE, PRINTED
SLV-60820	3/4 OD X .510 ID X 2.020" L GOLD ZINC
SLV-61055	.700 OD X .510 ID X .150 THICK GOLD ZINC
U-61156	AMC TRUNNION BUSHING 64-69
U-64234	AMC UPPER C-ARM BUSH, OUTER 64-69

QTY:  
2  
2  
2  
2  
4



Please refer to a factory service manual before any disassembly or reassembling of your vehicle for proper instructions. Check service manual to ensure proper torque specs during installation.

#### NOTE:

- Prothane bushings generally do **NOT** meet in the center. The "crush" or amount the bolt can be tightened is determined by the length of the sleeve.
- For all articulating bushings, make sure to apply SUPER GREASE (supplied) to **ALL SURFACES** of bushings that contact metal.
- For all stationary bushings, we recommend applying a light coat of lithium or teflon grease (not supplied) to OD and ID of bushings to aid installation.
- **REUSE** all factory hardware unless replacement pieces are supplied.

\*\*Prothane Motion Control highly recommends this and all our polyurethane suspension kits be installed by a qualified technician.\*\*

### INSTALLATION:

**\*\*NOTE: All factory bushings and inner sleeves MUST BE REMOVED before installing new PROTHANE bushings.\*\***

### Assembly View:

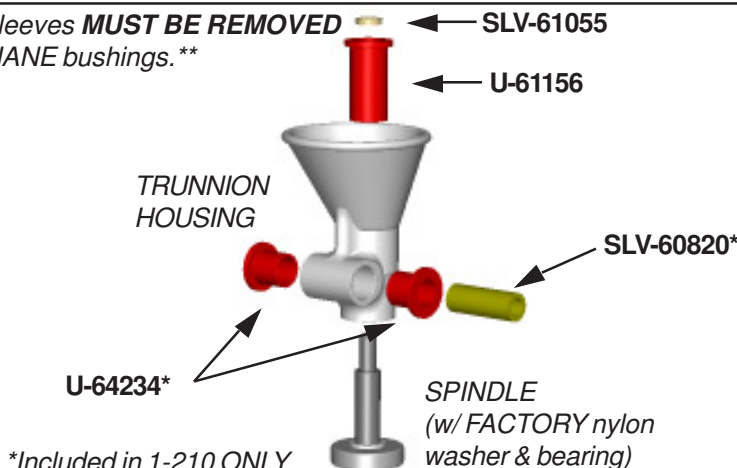

\*Included in 1-210 ONLY

FORM 1-209

FOR TECHNICAL ASSISTANCE CALL 1-888-PROTHANE