

INSTALLATION INSTRUCTIONS FOR NISSAN VEHICLES

PROTHANE Motion Control highly recommends this and all our polyurethane suspension kits be installed by a qualified automotive technician.

Kit #14-304 REAR CONTROL ARM BUSHINGS

It is recommended you work on one side of the vehicle at a time. In the event you get confused you can refer back to the other side for reassembly. **1)** Remove the complete spindle from vehicle. To do so remove the 36MM axle retaining nut, 22MM ball joint nut, 12MM brake caliper bolts (remove caliper from rotor), 17MM shock retaining nut, both upper control arm bolts and the toe link bolt. Separate the spindle from the ball joint and remove. **2)** Remove both upper control arms, toe link arm and lower control arm. **3)** Refer to diagram below. Remove rubber bushings "A" by pressing them out with a hydraulic press. Remove rubber bushings "B" by heating the center sleeve until the bond is broken with the rubber and then push the sleeve out. Next use a hack saw to cut thru the metal shell to release pressure and remove with a hammer and punch. Be careful not to damage arms or spindle while cutting.

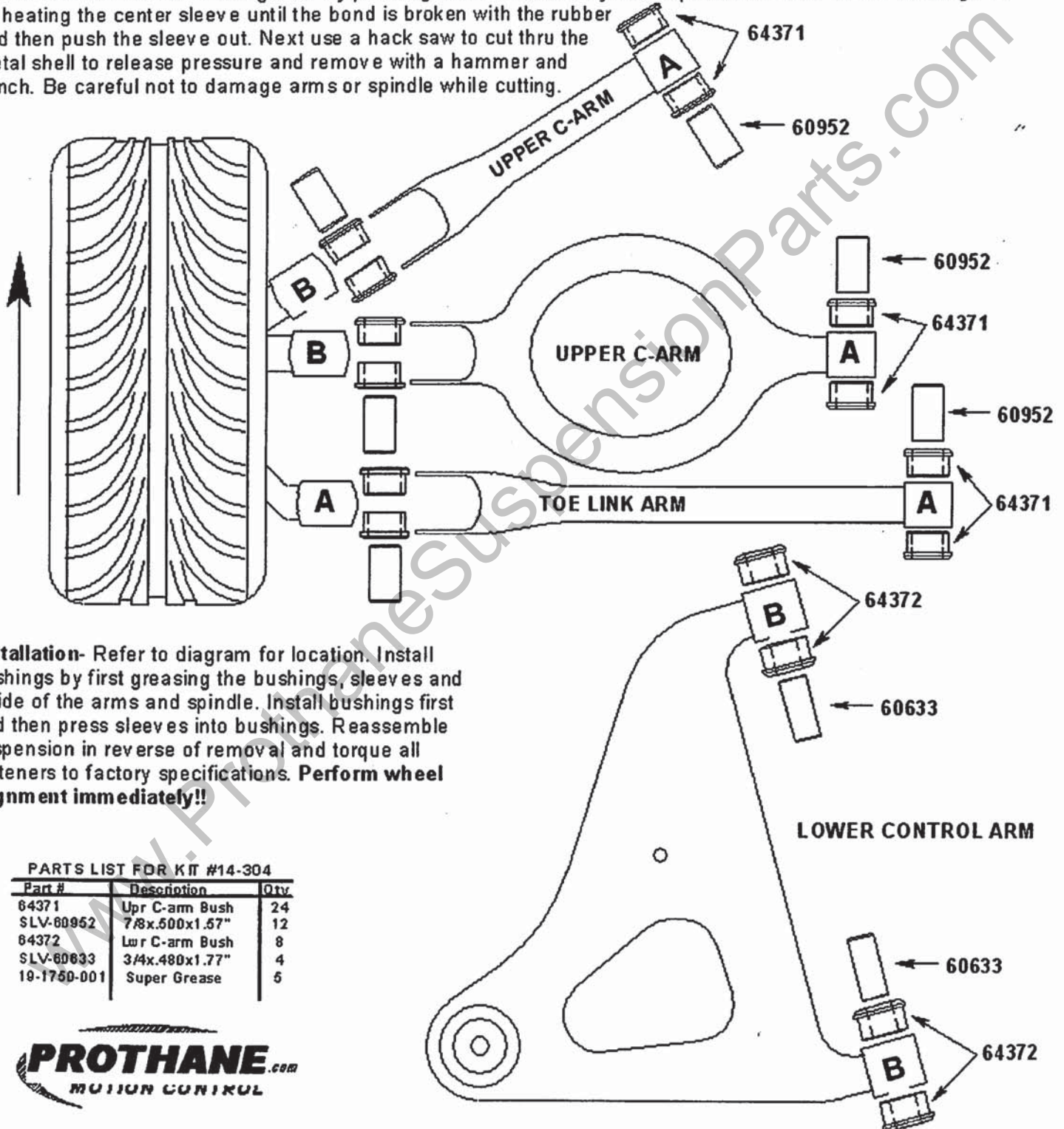

Installation- Refer to diagram for location. Install bushings by first greasing the bushings, sleeves and inside of the arms and spindle. Install bushings first and then press sleeves into bushings. Reassemble suspension in reverse of removal and torque all fasteners to factory specifications. **Perform wheel alignment immediately!!**

PARTS LIST FOR KIT #14-304

Part #	Description	Qty
64371	Upr C-arm Bush	24
SLV-60952	7/8x.500x1.57"	12
64372	Lwr C-arm Bush	8
SLV-60633	3/4x.480x1.77"	4
19-1750-001	Super Grease	5

PROTHANE.com
MOTION CONTROL