

INSTALLATION INSTRUCTIONS FOR KIT #4-214 PT CRUISER FRONT CONTROL ARM BUSHINGS

1. REMOVE THE FRONT CONTROL ARMS. IT IS RECOMMENDED YOU DO ONE SIDE AT A TIME SO YOU MAY REFER BACK TO THE ASSEMBLED SIDE OF THE SUSPENSION.
2. PRESS OUT THE VERTICAL BUSHING AND SLEEVE FROM THE SHELL. BE CAREFUL NOT TO SCAR THE I.D. OF THE SHELL OR TO DAMAGE THE ORIGINAL FACTORY SLEEVE BECAUSE YOU WILL BE REUSING IT.
3. REMOVE THE HORIZONTAL RUBBER BUSHING FROM THE ARM. REMOVAL OF THE ORIGINAL RUBBER BUSHING IS BEST ACCOMPLISHED BY PRESSING OUT THE BUSHING FROM THE ARM OR BY BURNING AWAY THE ORIGINAL RUBBER MATERIAL. **CAUTION-THIS SHOULD BE DONE BY A QUALIFIED SPECIALIST AS IT IS EXTREMELY DANGEROUS.**
4. REMOVE ALL REMAINING RUBBER MATERIAL AND CLEAN CONTACT SURFACES. THIS CAN BE DONE BY WIRE BRUSHING, SANDING, SAND BLASTING OR SIMILAR PROCESS.
5. LIGHTLY GREASE I.D., O.D. AND FLANGE OF BUSHINGS AND O.D. OF SLEEVES. ALSO I.D. OF CONTROL ARM AND ALL SURFACES THAT BUSHING CONTACTS. USE SPECIAL SUPER GREASE™ INCLUDED IN KIT. IF MORE GREASE IS NEEDED, OBTAIN SUPER GREASE™ FROM YOUR DEALER (PART #19-1750). IT IS RECOMMENDED THAT YOU USE ONLY OUR SPECIAL SUPER GREASE™.
6. INSTALL NEW BUSHINGS AS DIAGRAM SHOWS.
7. REINSTALL THE CONTROL ARMS ONTO THE VEHICLE AS PER THE MANUFACTURER'S SHOP MANUAL.
8. ALIGN FRONT OF VEHICLE.
9. AFTER DRIVING VEHICLE FOR APPROXIMATELY 50 MILES, RE-TORQUE CONTROL ARM RETAINING NUTS AND OR BOLTS TO BE SURE THEY HAVE NOT LOOSENED DUE TO THE BUSHINGS SETTLING IN. REPEAT THIS PROCEDURE AFTER VEHICLE IS RACED OR DRIVEN IN ABUSIVE CONDITIONS.

PARTS LIST FOR KIT #4-214

PART#	DESCRIPTION	QTY
U-64267	VERTICAL BUSHING(BOTTOM)	2
U-64266	VERTICAL BUSHING(TOP)	2
U-64265	HORIZONTAL BUSHING	4
SLV-60609	3/4"OD x 2.720" STEEL SLEEVE	2
19-1750-001	SUPER GREASE™	4

FRONT CONTROL ARM

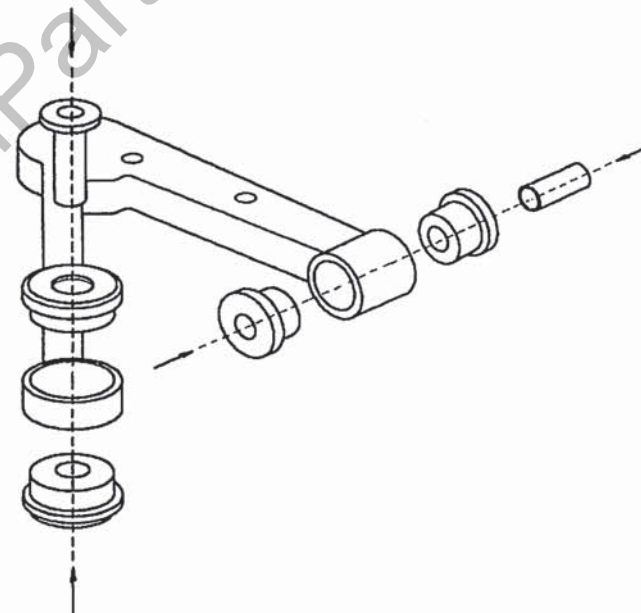

FRONT CONTROL ARM

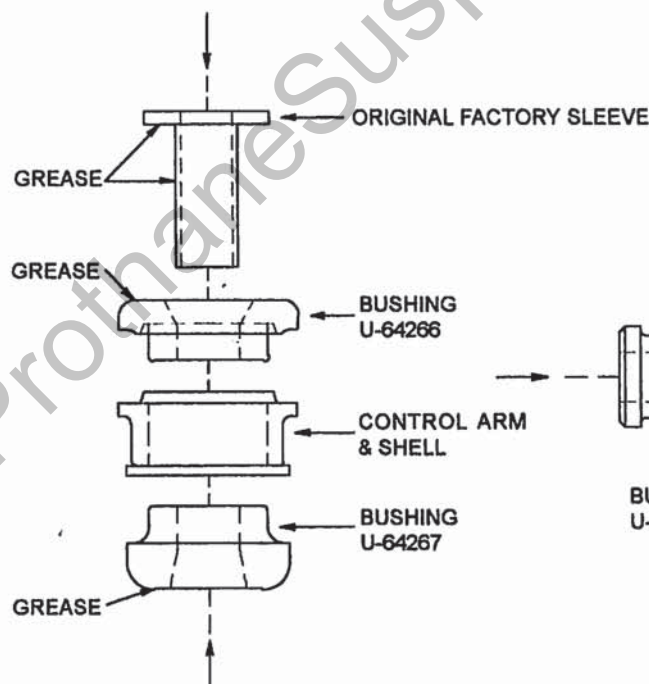
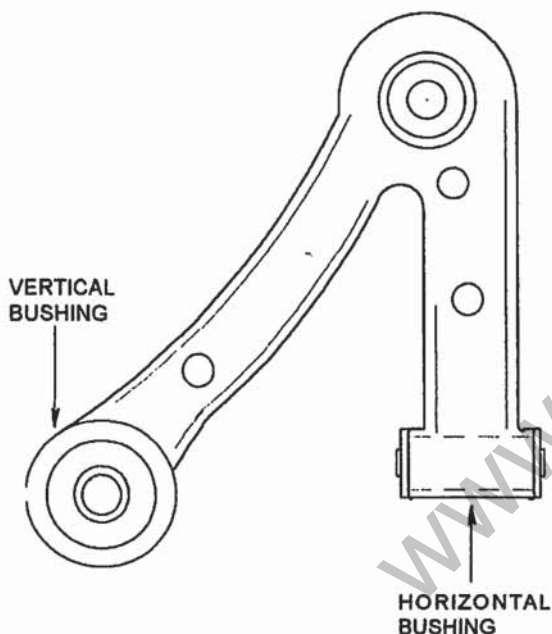

VERTICAL BUSHING

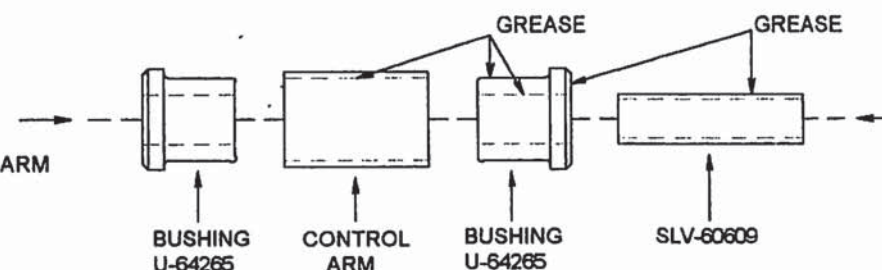

HORIZONTAL BUSHING